

# Washington State Retail Food Code Changes



Whatcom County  
**HEALTH**  
Department



Hello and welcome to Whatcom County Health Department's (WCHD) Food Safety Program presentation, in which we will be reviewing some of the main Washington State retail food code changes.

# Rule Change: Dogs in Outdoor and Indoor Seating Areas



This video will cover the Dogs in Outdoor and Indoor seating areas rule change that went into effect on March 1, 2022.

## Written Plan for Dogs Outside

---



Establishments will need to submit a plan for approval in order to have dogs in outdoor seating areas.

## Why Have a Plan

---



Why do you need to have a plan?

The short answer is because of bacteria that are naturally found in dogs and cause disease in humans. These are often transmitted via contact with feces, urine and saliva. In some cases, they are transmitted via mites, ticks or fleas.

## Maintain Cleanliness

---



The written plan should include a clean up plan.  
Outdoor seating areas must be maintained clean of animal waste.  
This also includes wet messes such as urine and vomit.

# Signage

---



Signage is also required.



## Example:



Here is an example of signage from an Oregon state facility.

# Outside entry only



Dogs may enter the seating area through an outside entry only.

# Outside entry only

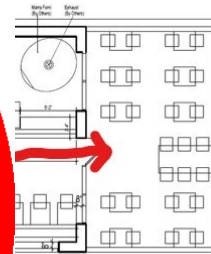

Dogs may not go through the restaurant to the outdoor seating area.

## Not on the furniture



Dogs are not allowed on chairs, benches, seats, tables or other fixtures meant for humans. They can remain leashed and away from these fixtures.

## Dining area only



Food or drink preparation, storage of dishware or food in the outdoor dining area is not allowed. This includes buffet lines whether served by a food worker or self-served.

Serving food or drinks is allowed.

# Leashed & Under Control



All dogs must be leashed and under control of the owner.

## Employees and Dogs

---



Employees may not have direct contact with dogs.

## Dog Bowls

---

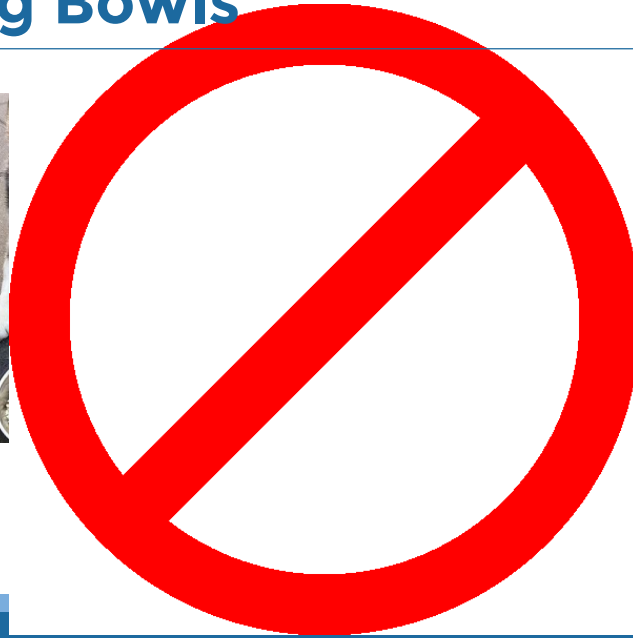

Food and water bowls may be provided by the food establishment.  
However, dishware for dogs cannot be washed in the food establishment.  
This includes the mop sink.

## Alternatives



This Photo by Unknown Author is licensed under [CC BY SA 4.0](#)



Dog owners may not feed dogs from restaurant provided dishware.

Alternatives:

- Disposable dishware.
- Owner owned dishware.

## Rule Change: Dogs in Indoor Seating Areas

Establishments that pour only non-TCS  
(Time/Temperature Control for Safety) beverages.



Moving on to dogs in indoor seating areas. Dogs are allowed inside only in food establishments that pour beverages produced by a food processing plant and serve non-TCS foods (Time/Temperature Control for Safety) from the original manufactured container.

## No Specialty Drinks

---



This means no mixing of specialty drinks such as martinis, cappuccinos, lattes, etc.

# Non-TCS Foods

May serve non-TCS foods from original container.

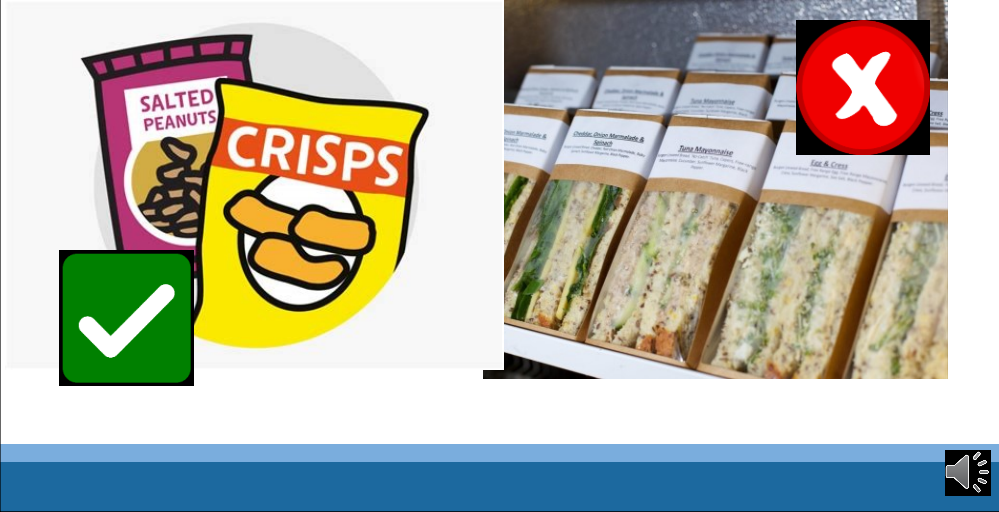

Food establishments may serve only non-TCS foods directly from the original package.

# Non-TCS Foods

---

Cannot use utensils or hands.



This means no use of utensils or hands.

## A Word of Caution

---

- Loose or stray dogs.
- Excessive barking.
- Aggressive dogs.
- Dog injures another dog.
- Dog injures a person.
- Destruction of property.
- Ill or sick dogs.
- Liability insurance.



As a word of caution: Before deciding on whether or not to have dogs in your seating area, think about what will happen in the case of:

- A loose or stray dog in your dog friendly area.
- Excessive barking or other aggressive behavior that can lead to possible injury of another dog, consumer or a staff member.
- Destruction of restaurant property such as cushions, wood, or knocking over tables, plates, glassware, etc.
  - Keep in mind, some owners tie their dog's leash to the furniture.
- Dogs that are or become ill.
- Lastly, think about your current situation and your insurance for dogs on premises.

# Dogs Outside/Inside Resources

- WCHD handout (Pet Dogs Outside)
- WA Department of Health toolkit (Pet Dogs on Premises)
- Both available here: [whatcomcounty.us/3232/Food-Safety](http://whatcomcounty.us/3232/Food-Safety)

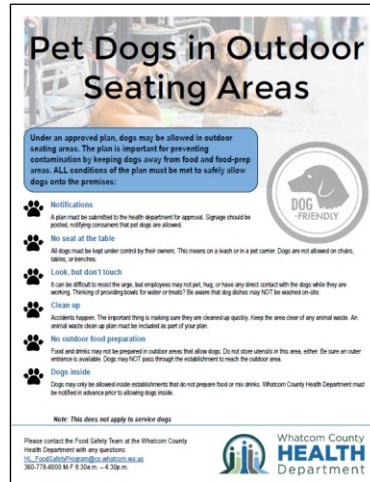

WCHD has created a handout with information about pet dogs outside. The Washington Department of Health created a toolkit establishments can use as well for pet dogs in both indoor and outdoor areas. Both of these resources are available on our Food Safety webpage.

**Thanks for Watching!**

